

## Alpha Dredger ESD10



### Description:

The Eureka Suction Dredgers are used for the cleaning of rivers, ponds and sand mining purposes. The suction dredger has a welded engine room that is always located above the water level. The control room is situated above the engine room. There are square floaters on both sides of the dredger. The water jet dredgers can be equipped with a high pressure jet pump for increased capacities, submersible dredge pumps or deep suction systems for winning at a depth of 10m. The dredger can easily be transported.

Dredger range:		Alpha 150	Alpha 200	Alpha 250	Alpha 300	Alpha 350	Alpha 400
Suction depth up to	[m]	10	10	10	10	10	10
Mixture	[m <sup>3</sup> /hr]	450	850	1600	2300	2450	3200
Solid material*	[m <sup>3</sup> /hr]	58	109	205	295	314	410
Solid material*	[ton/hr]	101	191	360	515	560	750
Total power**	[kW]	100	185	255	425	470	590
Jet power	[kW]	30	45	55	75	90	110
Suction pipe Ø	[mm]	200	250	300	350	400	450
Delivery pipe Ø	[mm]	150	200	250	300	350	400
Spherical passage	[mm]	100	110	160	190	185	220
Waterjet flow	[m <sup>3</sup> /hr]	100	150	200	250	250	300
Waterjet pressure	[bar]	7	7	7	7	8	8
Mooring cable Ø	[mm]	8	8	10	10	12	14
Mooring winch power	[ton]	1	1	1.5	1.5	2	2
Draft depth pontoons	[m]	0.5	0.6	0.7	0.8	0.9	1.0
Dry weight	[ton]	24	29	41	49	61	67
Dimensions pontoons	[m]	12x5x4	12x5x4	14x6½x5	14x6½x5	16x8x5½	16x8x5½
Length pipe up LxWxH	[m]	18x5x4	18x5x4	20x6½x5	20x6½x5	22x8x6	22x8x6
*Solid material = 70% < 2 mm 20% 2 - 32 mm 10% > 32 mm				**Power = A-rating or Electric			
<b>Options:</b>							
Spuds		Option	Option	Option	Option	Option	Option
Spud carrier		Option	Option	Option	Option	Option	Option
Automatic Dredge control		Option	Option	Option	Option	Included	Included
Cabin AC		Option	Option	Option	Option	Included	Included
Toilet		Option	Option	Option	Option	Included	Included
Kitchen		N/A	N/A	Option	Option	Option	Option

# Alpha Dredger ESD10

Main dimensions:

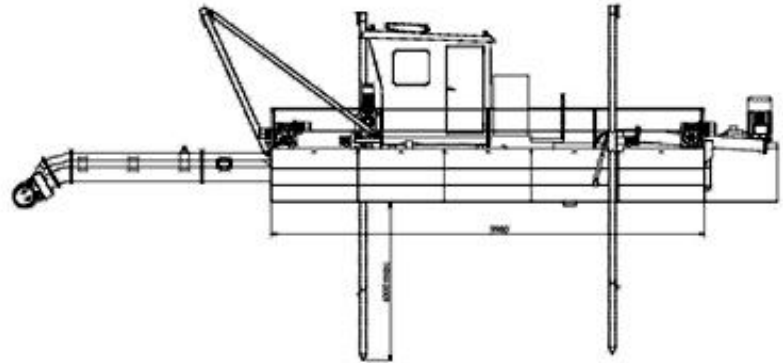
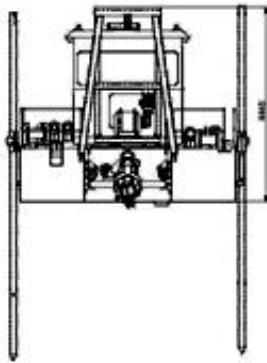
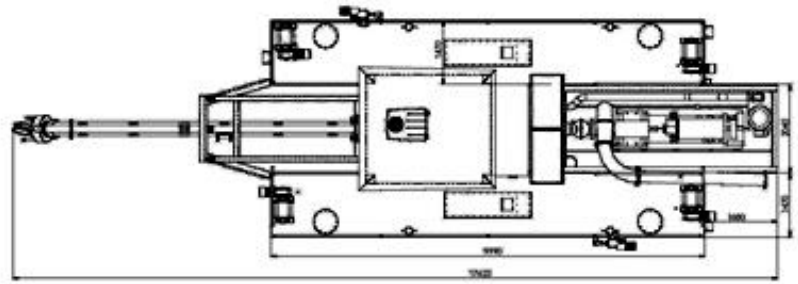

Metal Zodiac



Separation plant



Work pontoons



Conveyers

**EUREKA**  
www.eureka-bv.com

Maasstraat 3  
NL-7071 VR ULFT  
The Netherlands

Phone : 0 (031) 315 377 608  
Fax : 0 (031) 315 377 609  
Email : info@eureka-bv.com

All our quotations, all orders placed with us and all contracts concluded with us, are subject to the METAALUNIE CONDITIONS. These conditions are filed with the registrar of the District Court of Rotterdam. Upon request, the conditions of delivery and payment will be sent to you for free as well.